

Micro Swiss FlowTech™ Hotend for ELEGOO Neptune 4 Plus / 4 Max

INSTALLATION INSTRUCTIONS

Tools Required:

2.0mm Allen wrench

What's in the box:

PTFE Tube (30mm)
Heatsink
Copper Thermal Adapter

Titanium Mounting Screws (2x)
Heater Core
Silicone Sock

0.4mm Plated Brass Nozzle

STEP 1

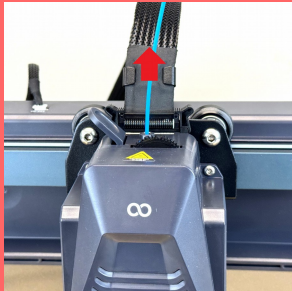

SAFETY / PREPARATION

- Unload the filament from the printer.
- Allow the hotend to cool down to room temperature.
- Power off the printer.
- Disconnect the power cable.

STEP 2

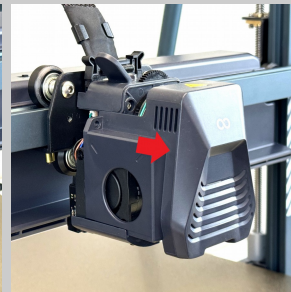

REMOVE THE FAN SHROUD

- Remove the two M3 screws securing the fan shroud.
(2.0mm Allen wrench)
- Pull the fan shroud off of the print head.

STEP 3

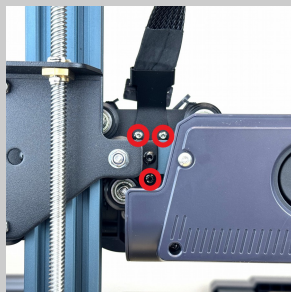
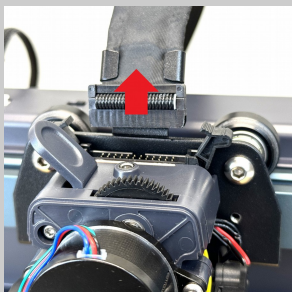

DETACH THE PRINT HEAD

- Disconnect the ribbon cable from the print head.
- Detach the print head from the carriage by unscrewing the three M3 screws on the back side of the carriage.
(2.0mm Allen wrench)

The carriage will need to be moved to the side of the large fan assembly to gain access to the three screws.

STEP 4

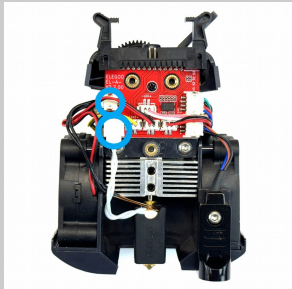

DISCONNECT THE ORIGINAL HOTEND CABLES

- Disconnect the original hotend's thermistor and heater cartridge cables from the breakout board.

STEP 5

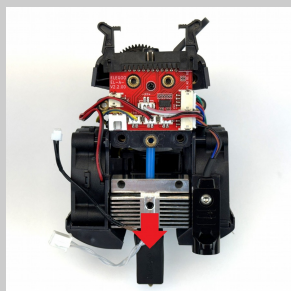
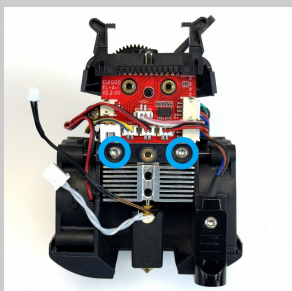

REMOVE THE ORIGINAL HOTEND

- Unscrew the two M3 screws securing the hotend and pull both the original hotend and PTFE tube out of the print head.
(2.0mm Allen wrench)

STEP 6

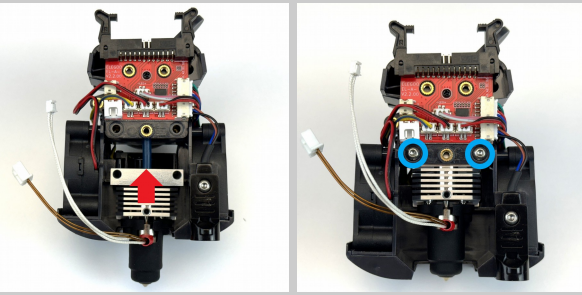

INSTALL THE NEW HOTEND

- Insert the FlowTech hotend and provided PTFE tube into the print head.
- **Be sure to use the PTFE tube provided with the kit.**
- Secure the hotend in place using two M3 screws. (2.0mm Allen wrench)

STEP 7

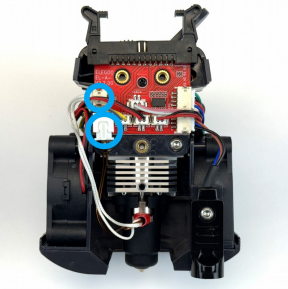

CONNECT THE HOTEND CABLES

- Connect the heater and thermistor cables to the matching ports on the breakout board.
- Tuck the brown heater wires into the gap on the left side of the heatsink.

STEP 8

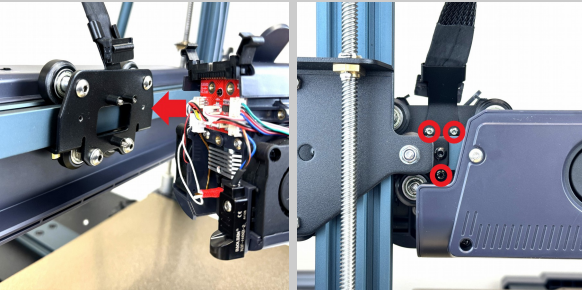

REATTACH THE PRINT HEAD

- Reattach the print head to the carriage using three M3 screws. (2.0mm Allen wrench)
- The carriage will need to be moved to the side of the large fan assembly to gain access to the three screws.

STEP 9

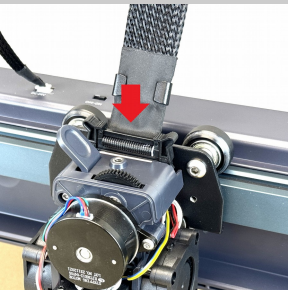

CONNECT THE RIBBON CABLE

- Reattach the ribbon cable to the print head.

STEP 10



REINSTALL THE FAN SHROUD

- Slide the fan shroud into position onto the print head.
- Reinstall the M3 screws on each side to secure the fan shroud. (2.0mm Allen wrench)

STEP 11

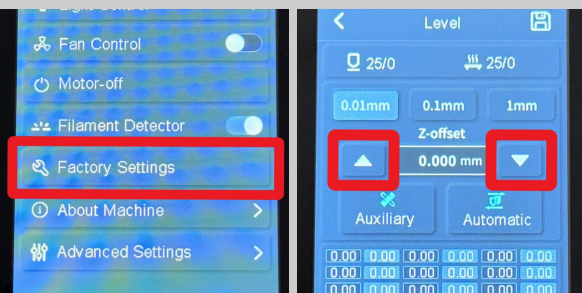

CALIBRATE THE PROBE

- Plug the power cable in and power on the 3D printer.
- Reset the Z offsets back to zero by selecting the following menu options on the 3D printer screen: **Settings**, **Factory Settings**, and then **Confirm**.
- Adjust the Z offsets by selecting: **Level**, **Confirm**, and then use the **up/down arrows** to set the nozzle height. Press the **save** icon in the top right of the screen.

Installation Complete.