

INSTRUCTION MANUAL

Remote-Controlled Air Filtration Kit For Bambu Lab P2S Compatible with AMS

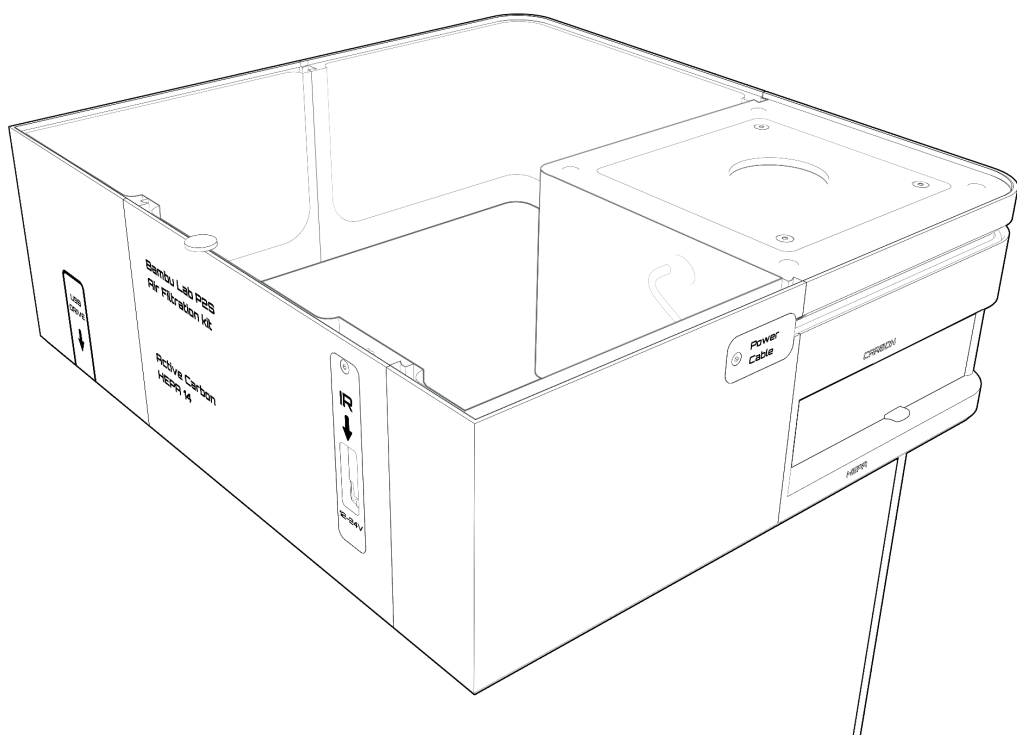

Find all assembly instructions :
<https://www.alveo3d.com/en/product/filter-hepa14-activated-carbon-bambu-lab-p2s/>

INSTALLATION RECOMMENDATIONS

Assembling the kit requires printing the parts that make up the structure. Here is the link to download the 3MF file:

https://www.alveo3d.com/wp-content/uploads/2026/02/kit-P2S-26_01_2026.zip

Assembly is carried out directly on the rear panel of the machine, at the location of the existing fan. No modification to the machine is required. The kit is compatible with AMS models on P2S.

The Bambu Lab P2S kit has been designed to offer maximum protection to users, without requiring structural modifications or the addition of an enclosure around the machine. Print the parts in PETG or any filament that can withstand a maximum temperature of 60°C.

System performance:

Thanks to the use of the P4D-R model, the kit ensures high efficiency in treating harmful emissions, including ultrafine particles and volatile organic compounds (VOCs).

The filter and fan (BLHP2432_H10) have been carefully selected to :

- Limit noise
- Provide sufficient airflow, ensuring lower pressure inside the printing chamber.
- Prevent polluted air leaks outside the machine.

The two-part design includes a guide that redirects recirculated air back into the machine, using the waste-extraction opening for filament change debris.

Additional benefits:

Thermal recirculation : This guide helps maintain a stable temperature in the enclosure, essential for printing filaments that require high temperatures.

SAFETY

Read the instructions before use

1. Power on the fan only after assembling the device with the protective grilles to avoid any risk of injury.
2. Use only the recommended supply voltages to power the system and avoid damaging the electronic components.
3. Avoid any contact with the fan when it is powered on.
4. Observe the following operating ranges :
 - Maximum temperature: 60°C
 - Optimal temperature: 0-40°C

Required materials

Non-supplied items required to assemble the kit

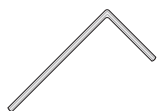

- Allen keys 2.0, 2.5 and 3.0 mm (hex)
(for M3, M4 screws)

Non-supplied items recommended for filter replacement

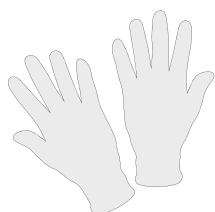

- Gloves



- FFP2 mask (minimum)

SUPPLIED MATERIALS

Items included in the kit*



- Remote control and IR receiver: 12 - 24V (battery included)



- 24 V power supply

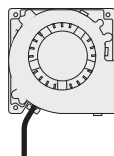

- Fan BLHP2432_H10

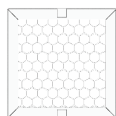

- P4D-R filter

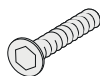

- 4x M4x16 black countersunk screws



- 3x M4x40 countersunk head screws

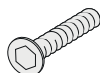

- 2x M4×14 pan head screws

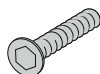

- 2x M3×12 black countersunk screws



- 9x M4 nuts, 2x M3 nuts



- 2x NBR70 O-rings



- Sealed plastic bag (for used filter)

PARTS TO PRINT

User-printed parts

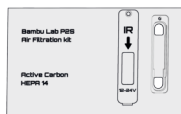

- Front side, IR cover



- Right side, Power Cable cover

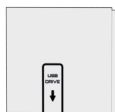

- Left side

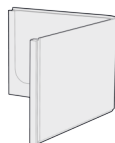

- Rear side

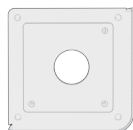

- Stage 1 - Fan



- Stage 2 - Carbon



- Stage 3 - HEPA



- Remote control holder



- Fan guard grille

EXPLODED VIEW - RISER

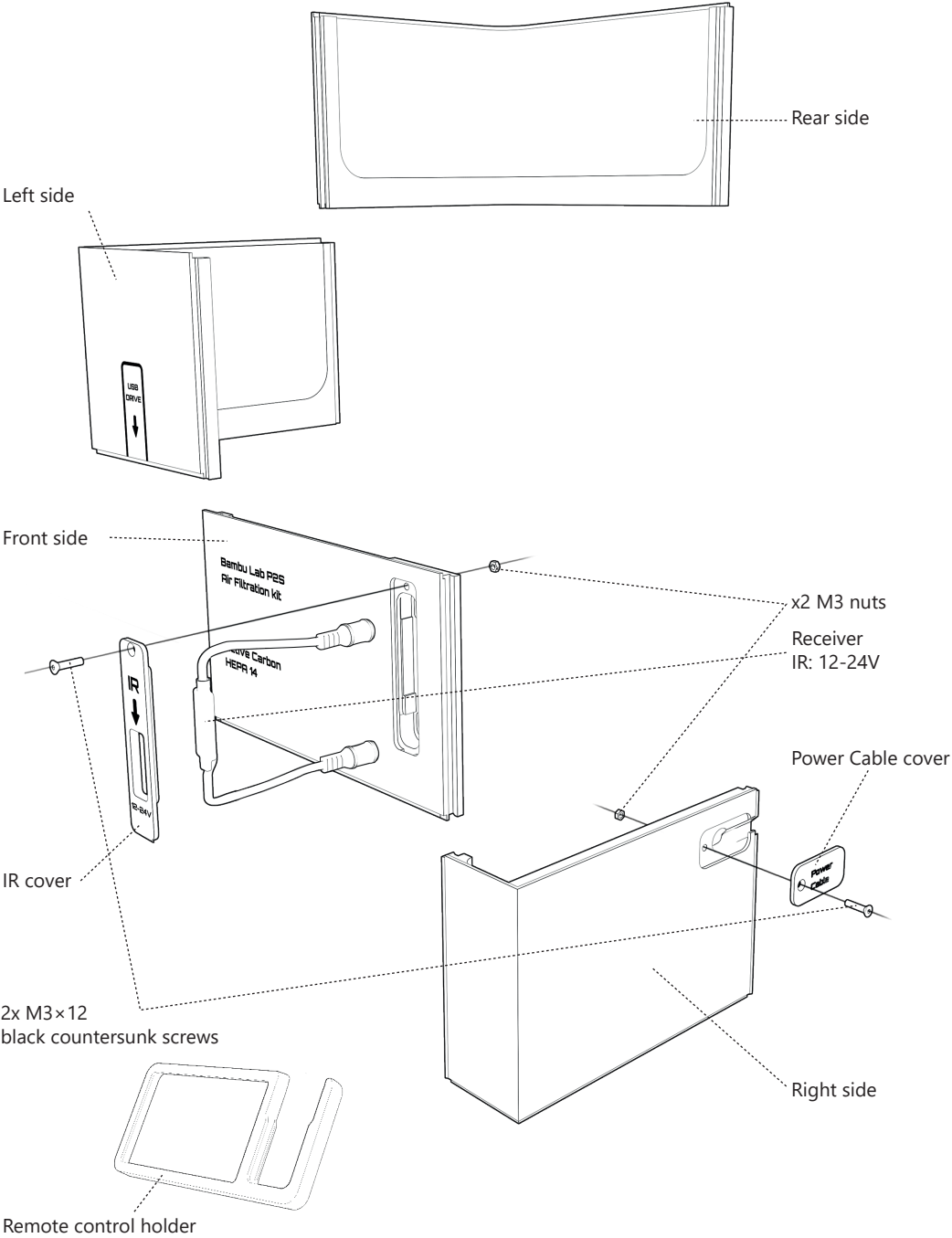

EXPLODED VIEW OF THE FAN AND FILTER STAGES

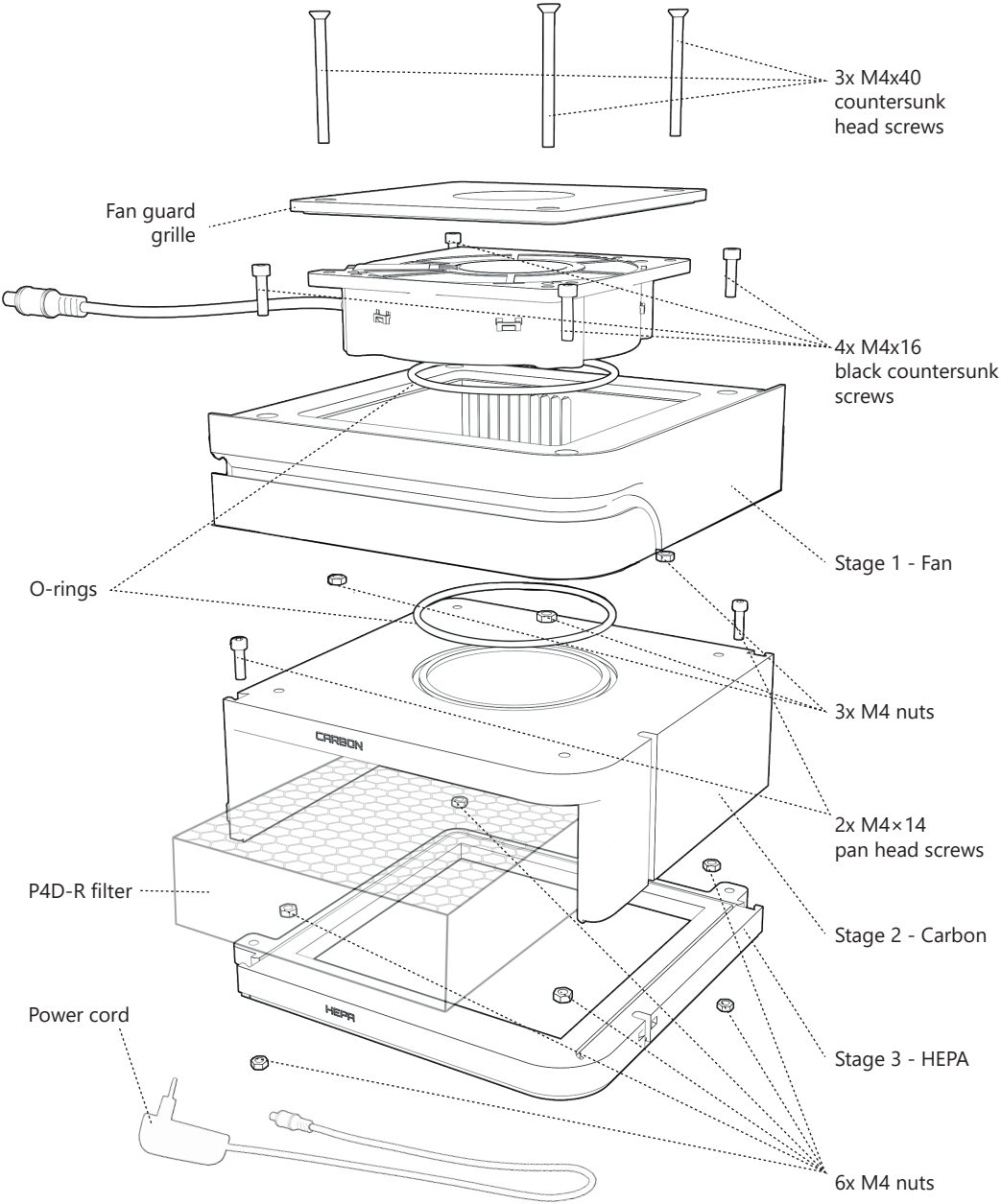

3. ASSEMBLY: STAGE 1, FAN

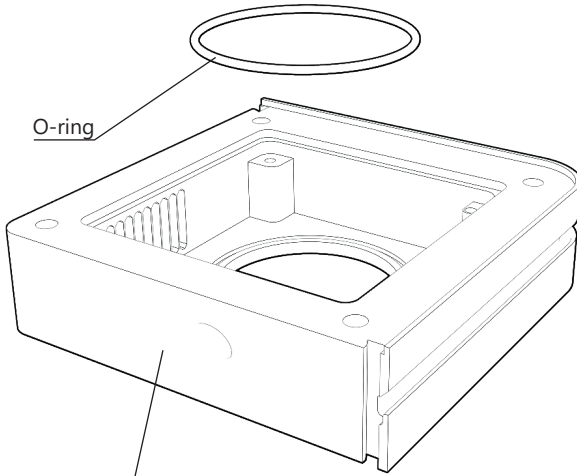

1. Insert the o-ring before placing the fan.

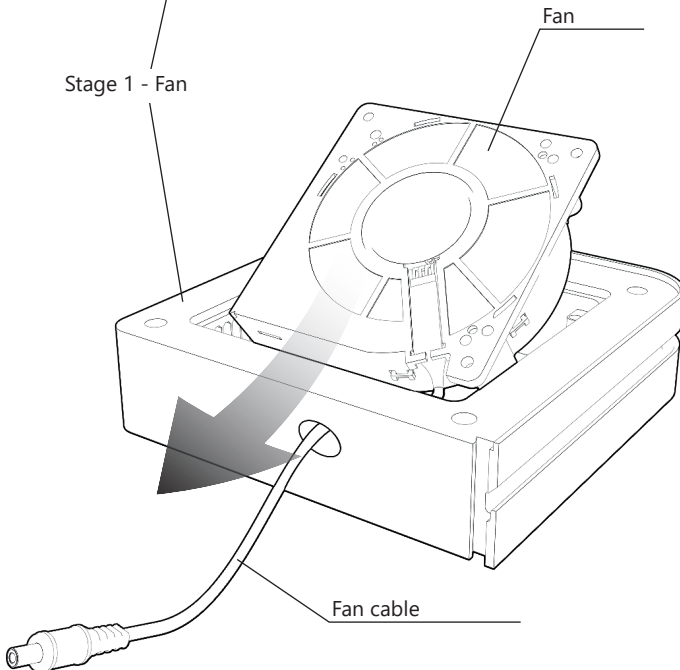

2. Insert the fan.

4. ASSEMBLY: STAGE 1

Install the fan guard grille on the fan and insert the 3 screws and the 3 nuts.

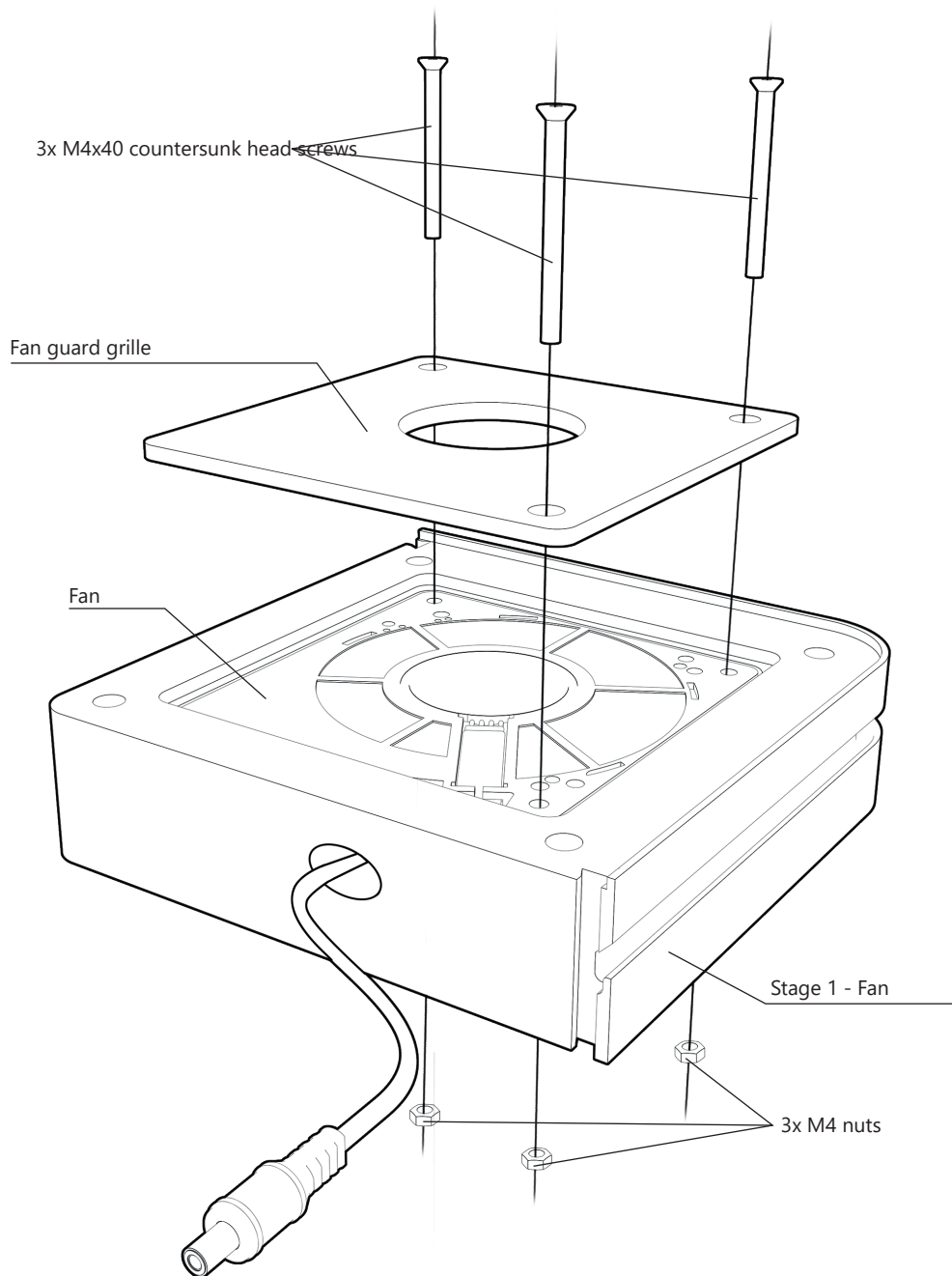

5. ASSEMBLY: STAGES 1 & 2

Prepare Stage 2 - Carbon, then position it under Stage 1 - Fan.

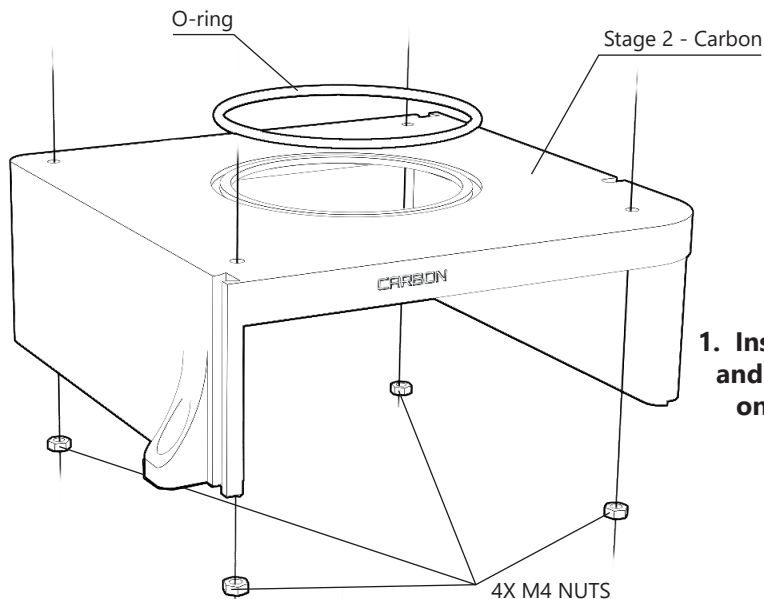

1. Insert the 4 M4 nuts and place the o-ring on top of stage 2.

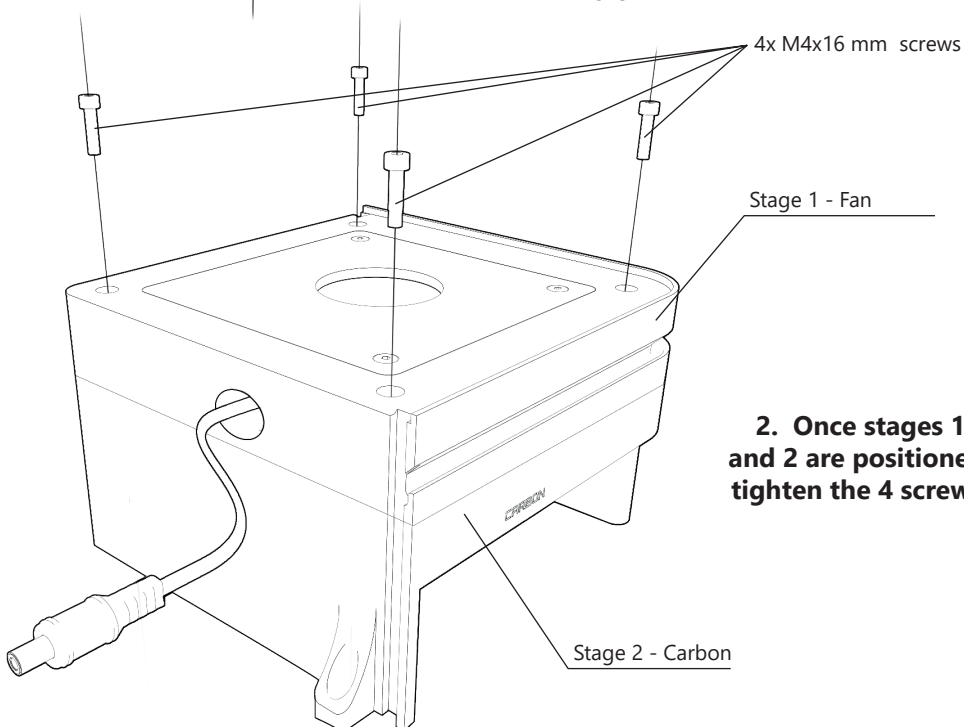

2. Once stages 1 and 2 are positioned, tighten the 4 screws.

5. ASSEMBLY: STAGE 3

Place stage 3 - HEPA under stage 2 - Carbon, ensuring it is correctly seated so you can insert the screws and then the nuts.

2x M4×14 socket head cap screws

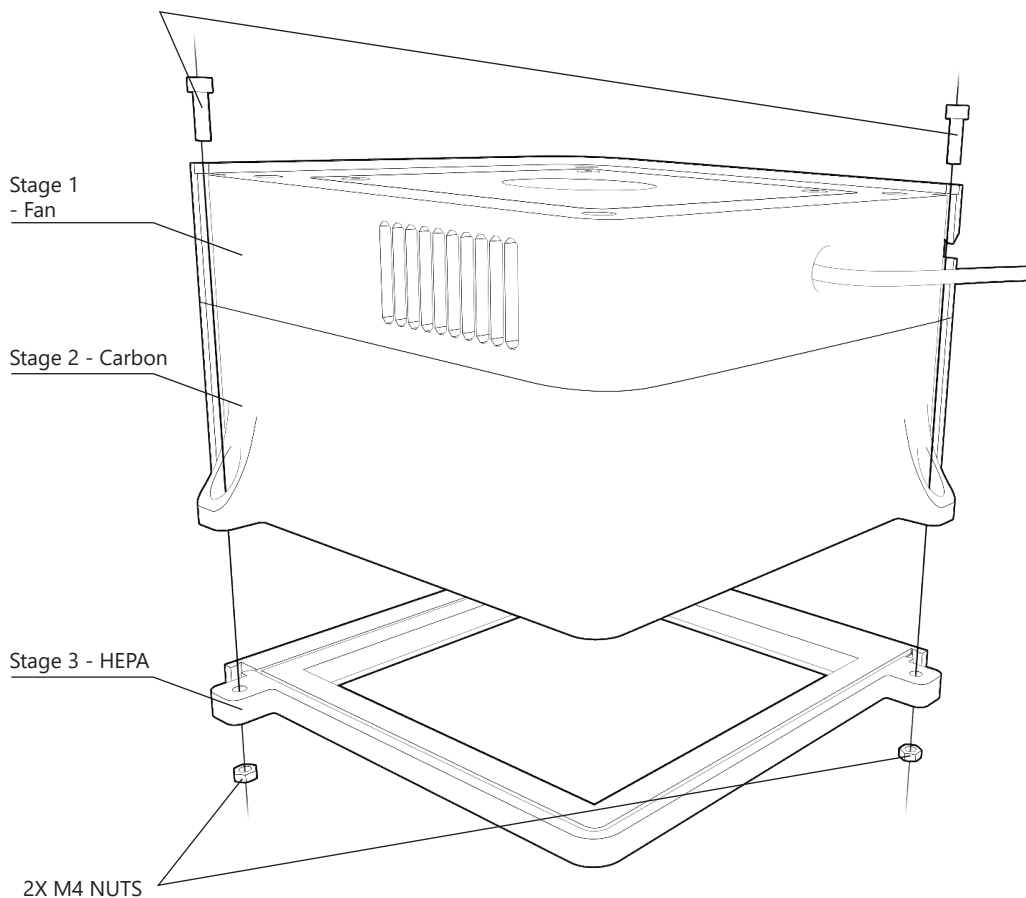

6. ASSEMBLE THE KIT SIDES

Once the fan and filter section is assembled (stages 1, 2, 3), attach each side at the locations indicated on page 4.

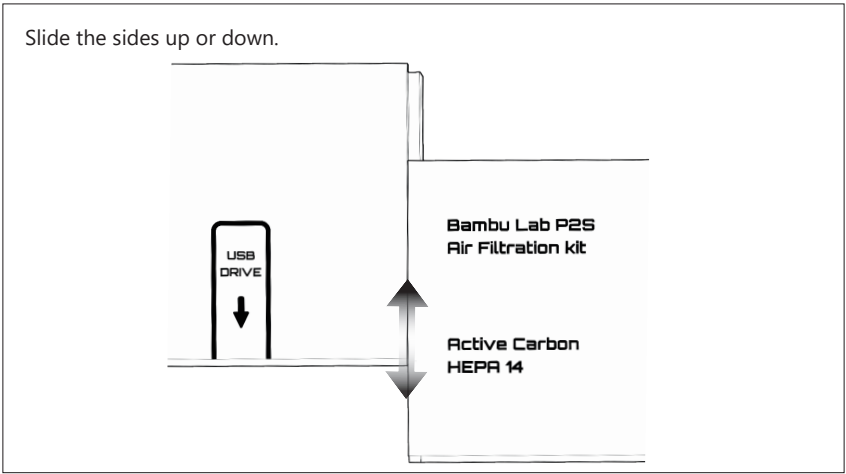
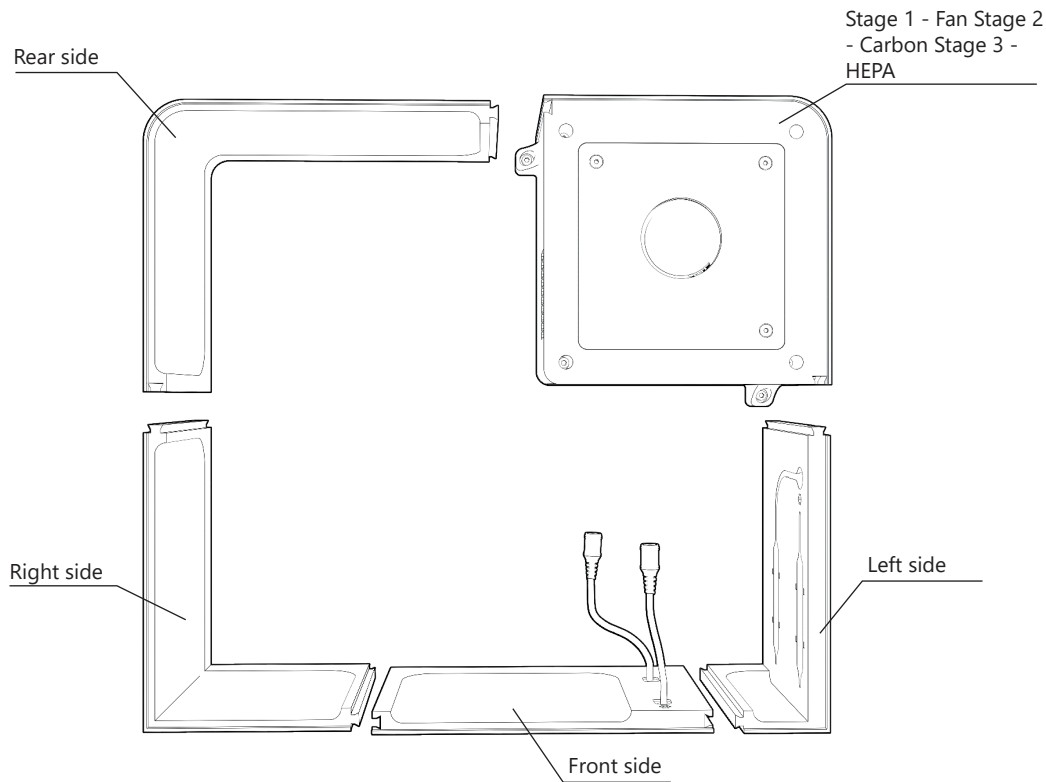

7. POSITION THE POWER SUPPLY CABLE

Route the power supply cable through the slot of the right side.

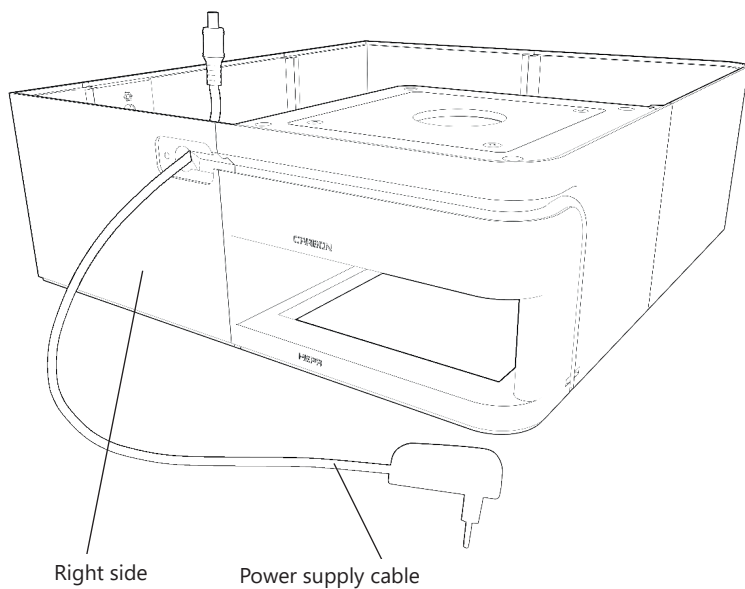

1. Insert the power supply cable.

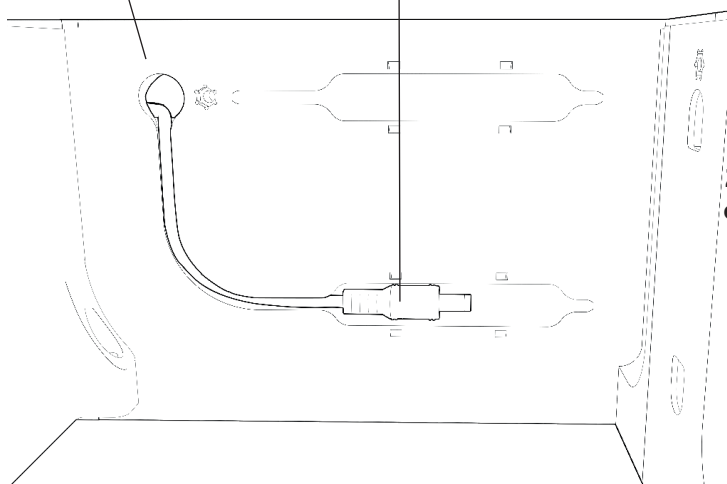

2. Adjust the cable on the cable holder inside the right side.

8. CONNECTORS

Connect each cable, making sure to plug them in and route them as shown below.

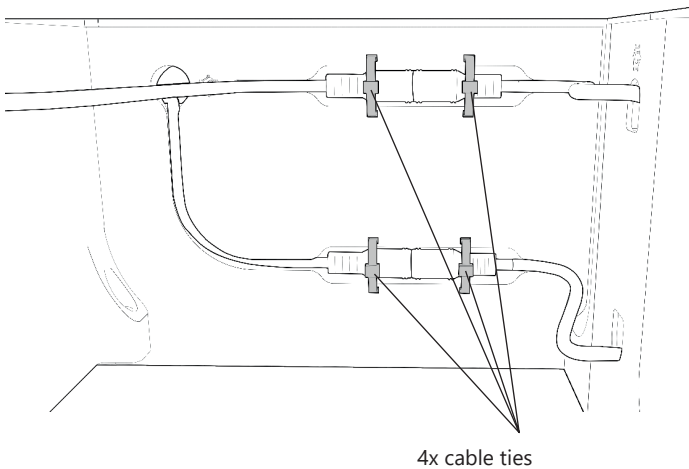
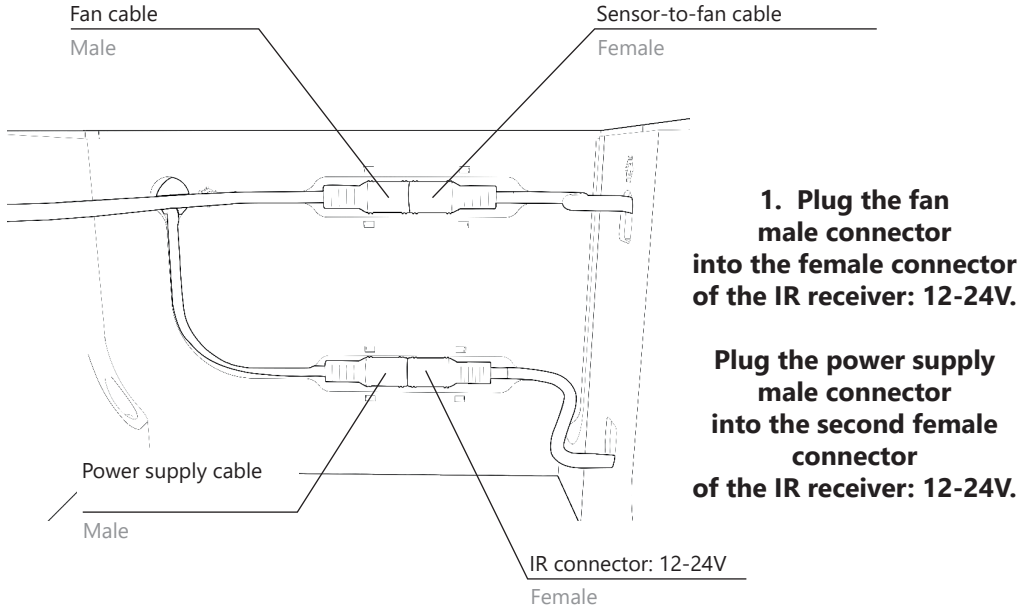

9. FINALIZING THE POWER SUPPLY CABLE

Install the power supply cable while adjusting its position, then add the Power Cable cover and the cable tie.

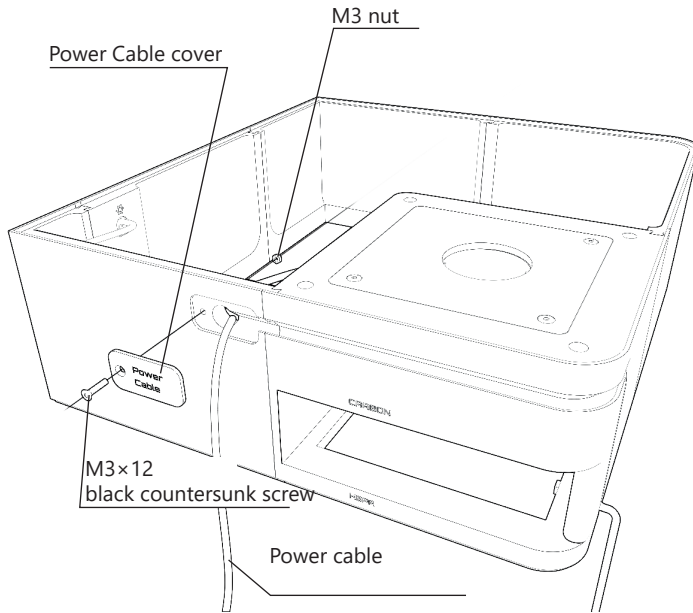

1. Insert the nut, fit the Power Cable cover and screw without pinching the cable.

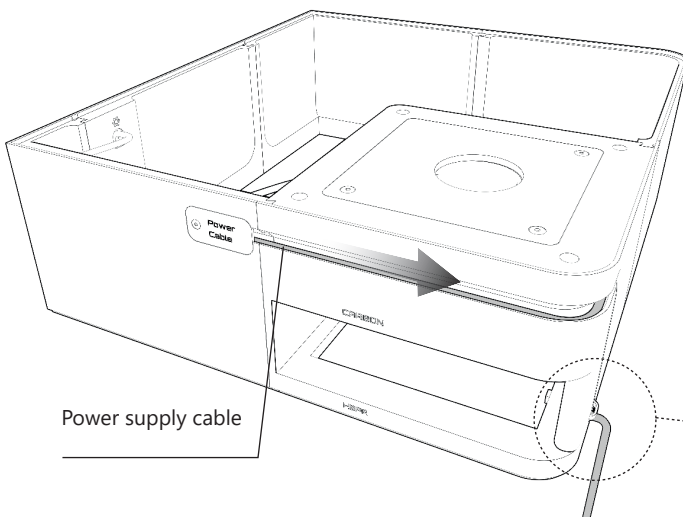

2. Route the cable power supply cable along the slot up to stage 3 - HEPA.

Add a cable tie to secure the cable.

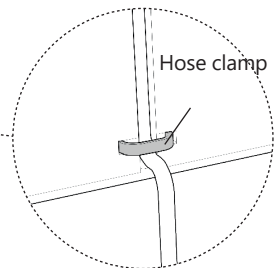

10. INSTALLING THE KIT ON THE MACHINE

Install the prepared kit on the machine, then clip the remote holder onto the screen located on the left side of the printer.

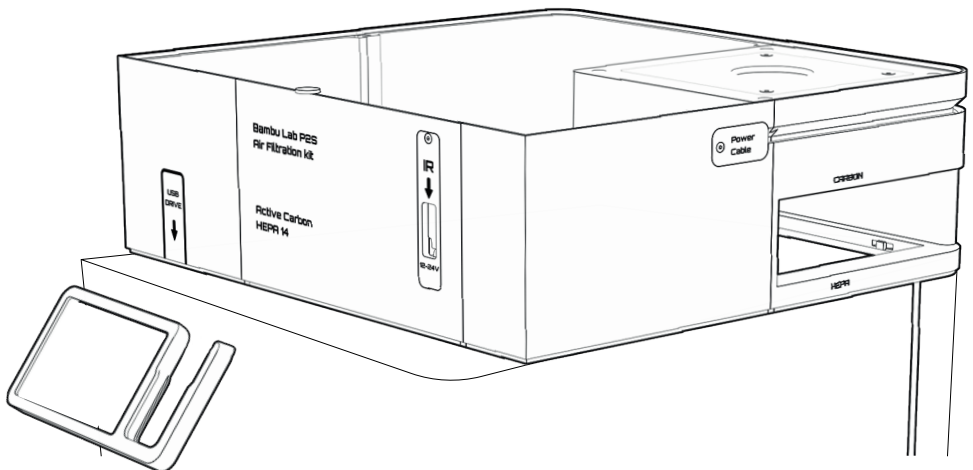
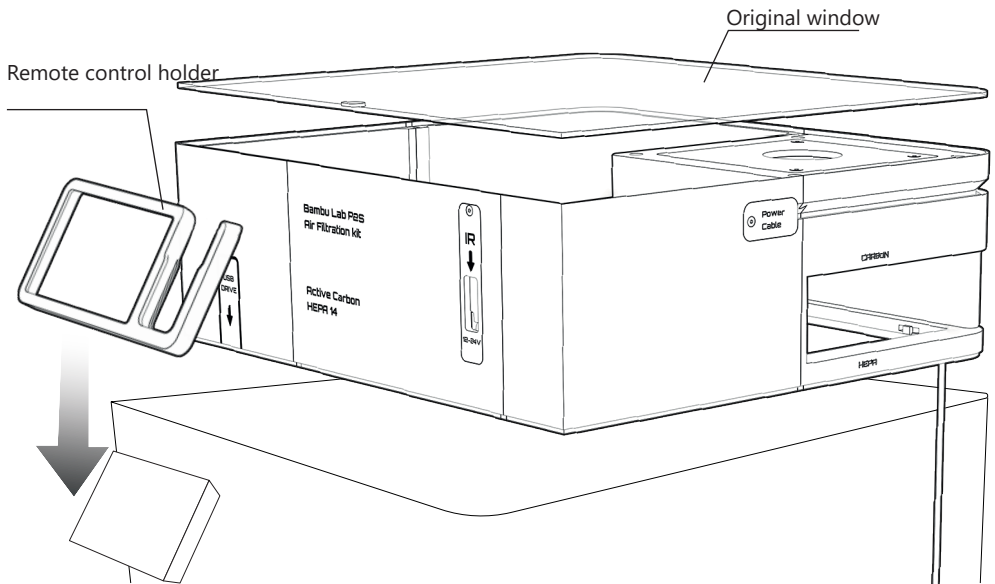

11. FILTER: INSTALLATION

Insert the filter fully until it stops.

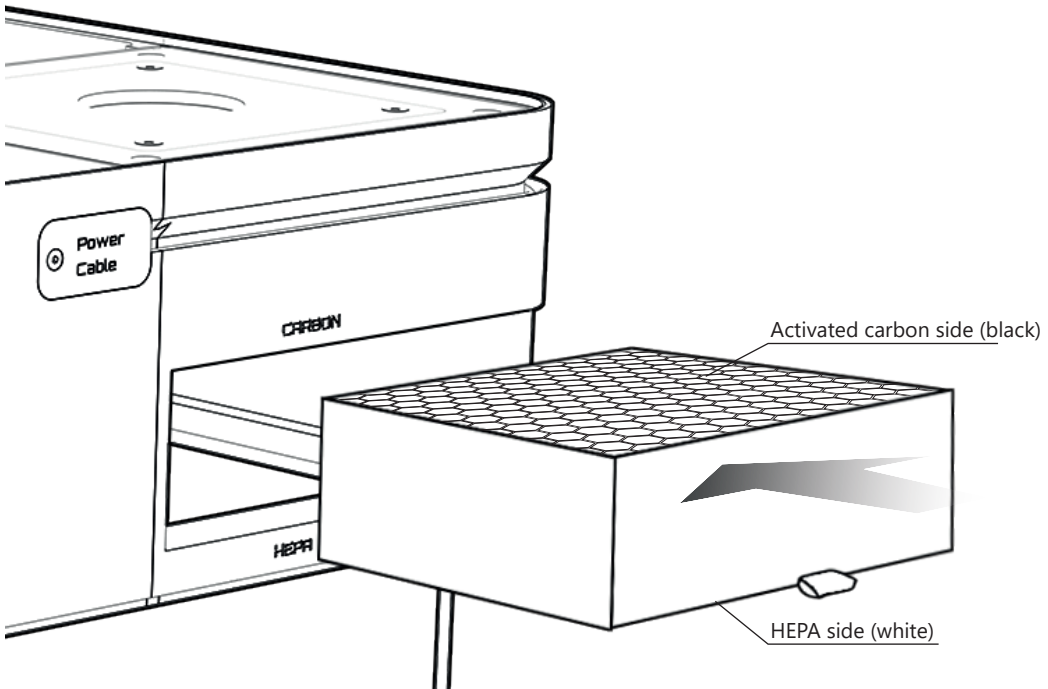

12. USING THE REMOTE HOLDER

Remove the plastic tab that insulates the battery from the connector on the remote control.

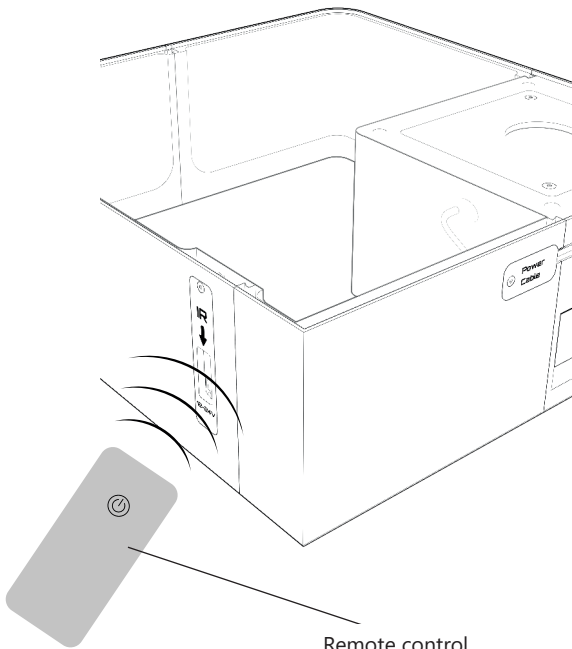

- 1. Press the button on the remote control pointing it towards the IR receiver: 12-24V to turn the fan on and/or off.**

Remote control

Remote control holder

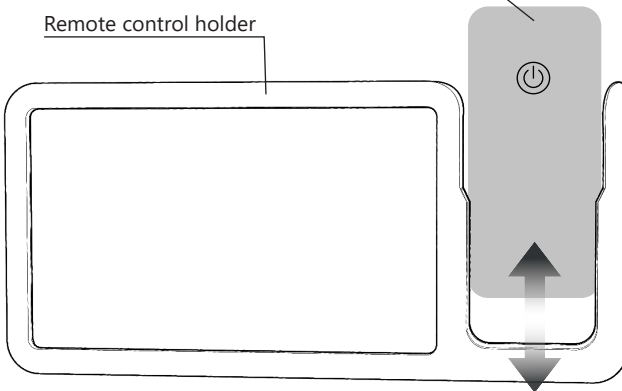

- 2. After use, insert the remote control into the remote control holder.**

13. FILTER: REPLACEMENT

When the filter needs to be replaced, remove it using the visible tab.

⚠ If the filter is difficult to remove, use one hand to push the filter to the left to pull it out more easily.

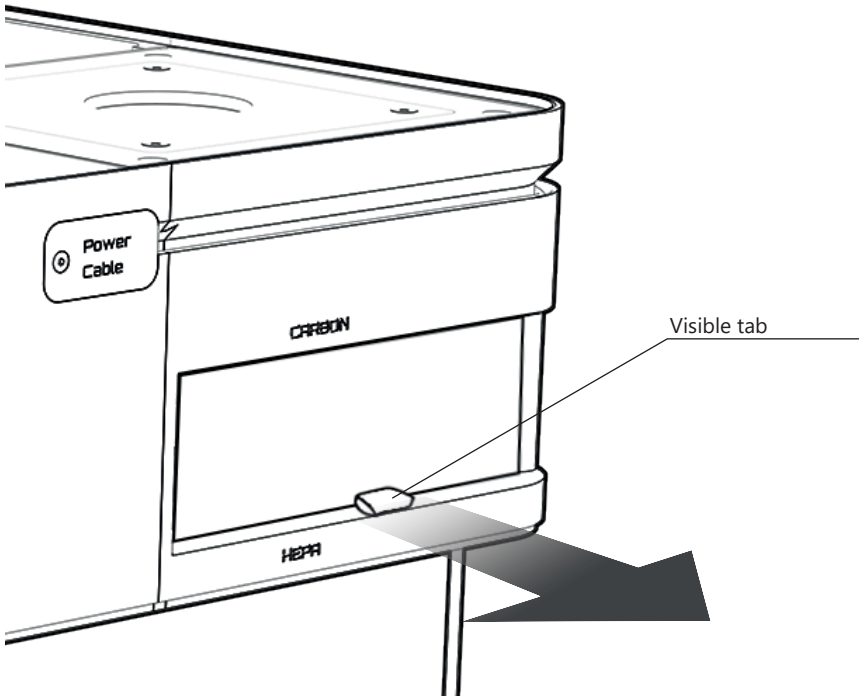

Filter service life

The service life of a P4D-R filter depends on many factors such as: the type of plastic used for printing, the melting temperature, the concentration of nanoparticles and volatile organic compounds (VOCs), humidity level ... We recommend replacing the filter according to the table below:

Filter replacement	Heavy use	Occasional use
	4 months	8 months

We recommend not exceeding 900 hours of use per filter.

Filter replacement tracking:

	Date
Purchase date	
Replacement 1	
Replacement 2	
Replacement 3	
Replacement 4	
Replacement 5	
Replacement 6	
Replacement 7	
Replacement 8	
Replacement 9	
Replacement 10	

NOTES:

[illegible]

NOTES:

22

Breathe Easy! You're Filtering!

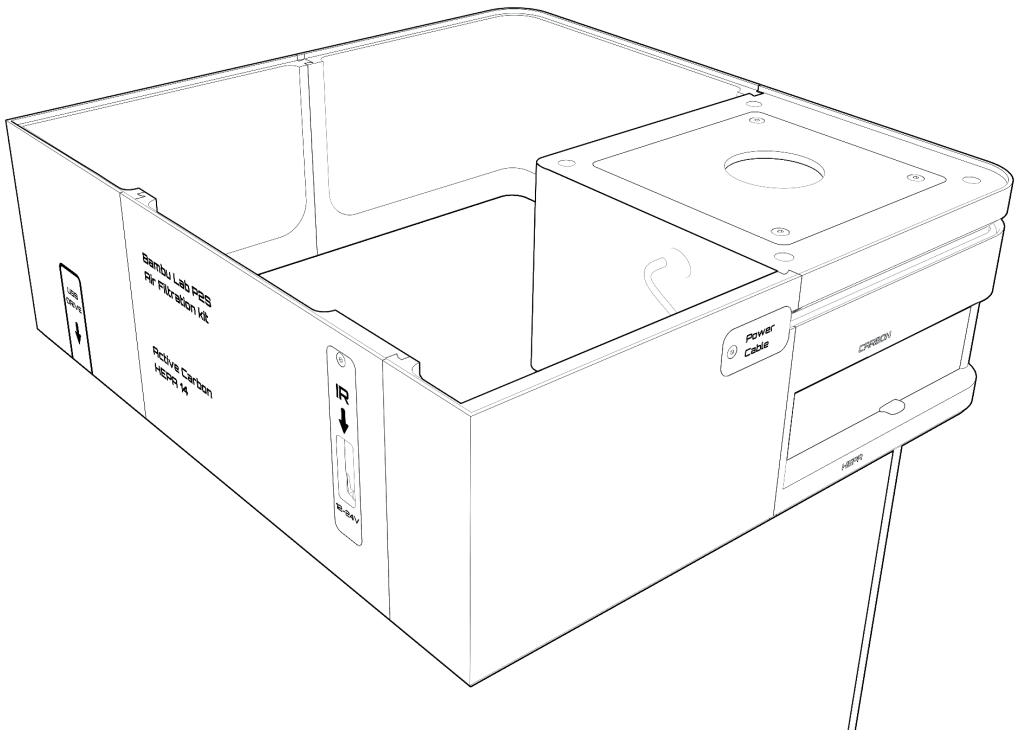

Designed in France

ALVEO3D
460 Rue de la Leyse
73000 Chambéry
France

contact@alveo3d.com
